

CONNECTOR ASSEMBLY
 TAPE

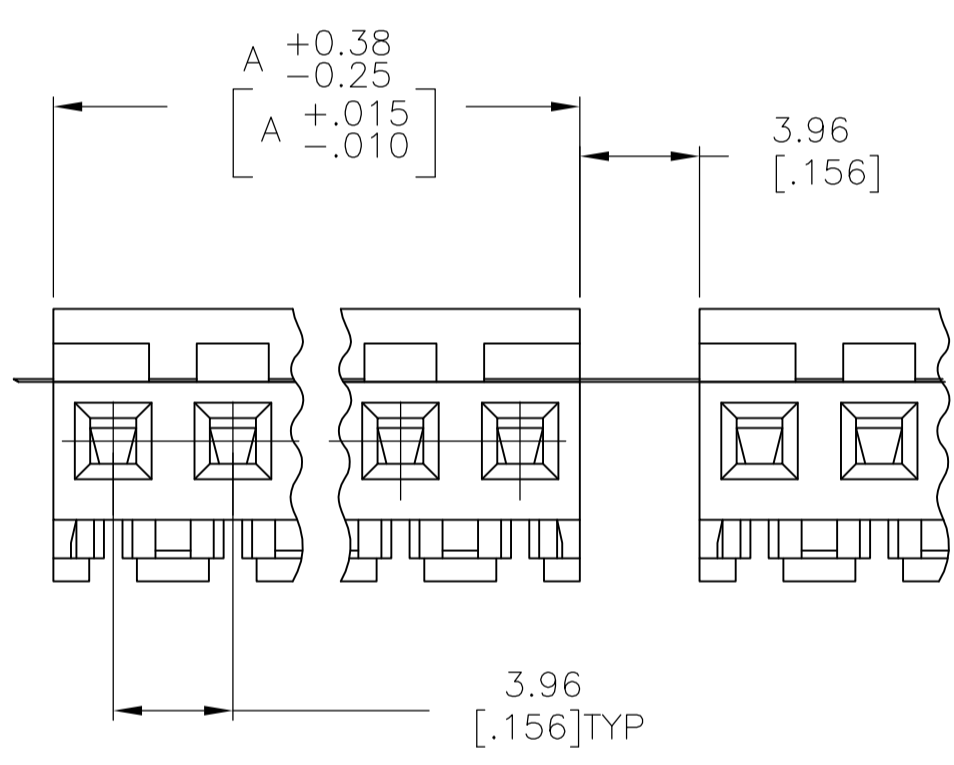
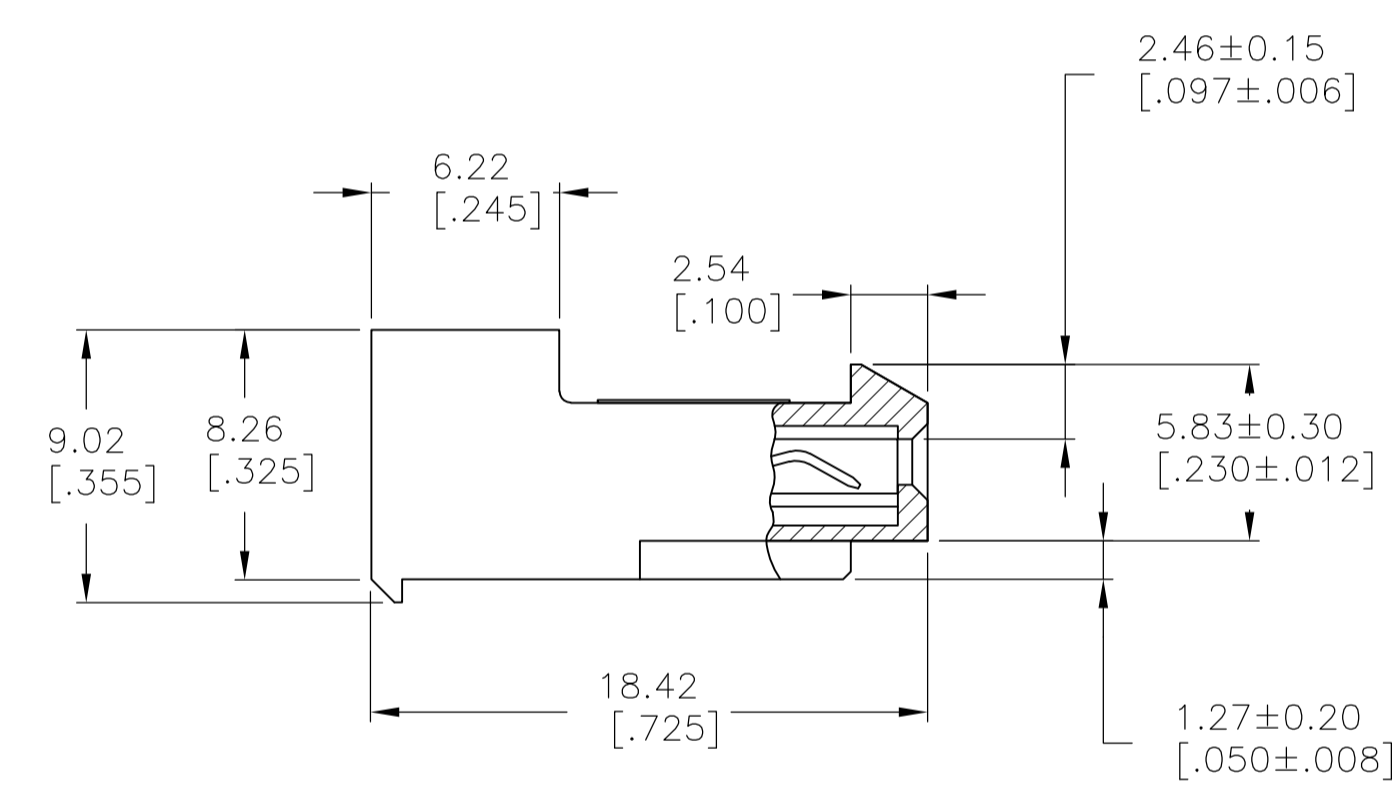

- 1 MATERIAL: CONTACTS - 0.30[.012] THICK COPPER ALLOY BRIGHT TIN-LEAD 0.00203[.000080] MIN THICK FOR CONTACTS 640473-2 THRU 2-640473-4 MATTE WHISKER MITIGATED TIN 0.00203[.000080] MIN THICKNESS OVER NICKEL UNDERPLATE FOR 3-640473-2 THRU 5-640473-4
2. CONTACTS ACCEPT 20 AWG WIRE WITH 2.41[.095] MAX INSULATION DIAMETER.
3. CONTACTS MUST ACCEPT 1.14±0.03[0.459±.001] SQUARE POST AND REMAIN LOCKED IN POSITION.
- 4 IDENTIFICATION NUMBER FOR LAST CIRCUIT MAY NOT APPEAR ON ALL ASSEMBLIES.
5. DIMENSIONS IN BRACKETS ARE IN INCHES.
6. HOUSING FEATURES ARE: CLOSED END WITH LOCKING RAMP.

95.10	[3.744]	24	5-640473-4
91.13	[3.588]	23	5-640473-3
87.17	[3.432]	22	5-640473-2
83.21	[3.276]	21	5-640473-1
79.25	[3.120]	20	5-640473-0
75.29	[2.964]	19	4-640473-9
71.32	[2.808]	18	4-640473-8
67.36	[2.652]	17	4-640473-7
63.40	[2.496]	16	4-640473-6
59.44	[2.340]	15	4-640473-5
55.47	[2.184]	14	4-640473-4
51.51	[2.028]	13	4-640473-3
47.55	[1.872]	12	4-640473-2
43.59	[1.716]	11	4-640473-1
39.62	[1.560]	10	4-640473-0
35.66	[1.404]	9	3-640473-9
31.70	[1.248]	8	3-640473-8
27.74	[1.092]	7	3-640473-7
23.77	[.936]	6	3-640473-6
19.81	[.780]	5	3-640473-5
15.85	[.624]	4	3-640473-4
11.89	[.468]	3	3-640473-3
7.92	[.312]	2	3-640473-2
95.10	[3.744]	24	2-640473-4
91.13	[3.588]	23	2-640473-3
87.17	[3.432]	22	2-640473-2
83.21	[3.276]	21	2-640473-1
79.25	[3.120]	20	2-640473-0
75.29	[2.964]	19	1-640473-9
71.32	[2.808]	18	1-640473-8
67.36	[2.652]	17	1-640473-7
63.40	[2.496]	16	1-640473-6
59.44	[2.340]	15	1-640473-5
55.47	[2.184]	14	1-640473-4
51.51	[2.028]	13	1-640473-3
47.55	[1.872]	12	1-640473-2
43.59	[1.716]	11	1-640473-1
39.62	[1.560]	10	1-640473-0
35.66	[1.404]	9	640473-9
31.70	[1.248]	8	640473-8
27.74	[1.092]	7	640473-7
23.77	[.936]	6	640473-6
19.81	[.780]	5	640473-5
15.85	[.624]	4	640473-4
11.89	[.468]	3	640473-3
7.92	[.312]	2	640473-2
DIM A		NO OF CIRCUITS	PART NO

METRIC

THIS DRAWING IS A CONTROLLED DOCUMENT.

DIMENSIONS: mm [INCHES]	TOLERANCES UNLESS OTHERWISE SPECIFIED:	0 PLC ± -	1 PLC ± -	2 PLC ± -	3 PLC ± 0.13 [.005]	4 PLC ± -	ANGLES ± -
THIS DRAWING IS A CONTROLLED DOCUMENT. D. LEWIS 12-2-91 R. SWING 12-2-91 D. CLARK 19-2-91		Tyco Electronics Corporation Harrisburg, Pa 17105-3608 NAME: MTA-156 CONNECTOR ASSEMBLY, 20 AWG, STANDARD TAPE MOUNTED PRODUCT SPEC: 108-1051 APPLICATION SPEC: 114-1020 SIZE: A1 CASE CODE: 00779 DRAWING NO: 640473 WEIGHT: - RESTRICTED TO: - CUSTOMER DRAWING: - SCALE: 4:1 SHEET: 1 of 1 REV: S					